

# Beckton Parks Masterplan



**Map**

**Inside**







# Contents

East  
architecture  
landscape  
urban design  
east.uk.com

with  
Peter Massini



Foreword	6
How to use this booklet	8
Introduction	10
Beckton Parks vision	12
So much to do	14
■ Parks for all	16
■ Urban sports	20
■ Green skills	24
■ Inclusive play	28
■ Ecology	32
■ Events & culture	40

# Foreword

## Executive summary

The Beckton Parks Masterplan presents an exciting opportunity to revitalise the parks and green spaces of Beckton and to protect and improve them for years to come. Adoption of the Beckton Parks Masterplan represents a serious investment in public space that we know is so important to local people and is vital for the health and well-being of the community.

By working with local people, community groups, schools and sports clubs throughout the development of this masterplan, it has been designed to ensure that it fulfils their needs and vision. The final designs have been developed and refined by local people which will guarantee that the Beckton Parks Masterplan will deliver for the local area for years to come.

Championed by former Deputy Mayor and Cabinet Member for the Environment and Sustainable Transport, James Asser, Newham Council are committed to delivery of a gold standard green space that will benefit everyone living and working in Beckton and Custom House wards and in Newham as a whole. The masterplan presents a framework for a series of schemes and improvements for delivery over time on a project-by-project basis and safeguards these spaces in line with the community priorities for the future.

The masterplan proposes opportunities to increase accessibility as well as improve connectivity between the local communities. It puts environmental sustainability and ensuring everyone can make use of the facilities at the heart of the plan.

The masterplan proposes a sports and leisure hub that will allow the parks to be used for a mix of play, social and formal facilities plus the introduction of an urban sports offer. Improvements to the parks will see the introduction of cultural, social and well-being activities supported by community events and facilities, nature play trails, shaded seating areas and nature areas.

The development of a community farm with a green skills hub will create opportunities for climate and sustainability focused learning and education that supports community groups, school visits and accredited learning opportunities such as apprenticeships and training.

The improvements to the lake in the north of the parks will significantly improve the habitat for wildlife and improve the experience for visitors. The introduction of a huge inclusive and diverse play park will provide a fully accessible play offer that will be designed for and with the community who will benefit from it.

This will create a substantial play area meeting a demand for SEND accessible play, which we know is needed in the borough.

The parks will benefit further from the reopening and redesigning of closed facilities such as community halls, toilets and cafés that will also create opportunities for small businesses and local organisations.

This masterplan brings together the ideas and work of many people over a two year period and presents a once in a generation opportunity to create a network of community spaces and parks that will make Beckton a place to visit. This is an exciting future for the area and will set the standard for what can be achieved in our parks.



Councillor Miraj Patel  
Deputy Cabinet Member for the Environment  
June 2024





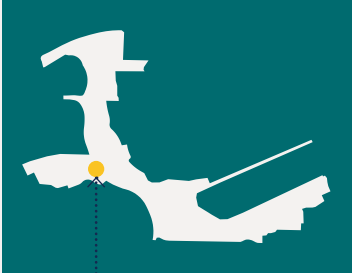

Refer to the yellow dots on the map at the top of each page to understand where in the park the improvements will take place.

<b>Parks for all</b>	<b>Urban sports</b>	<b>Green skills</b>
<b>Inclusive play</b>	<b>Ecology</b>	<b>Events &amp; culture</b>

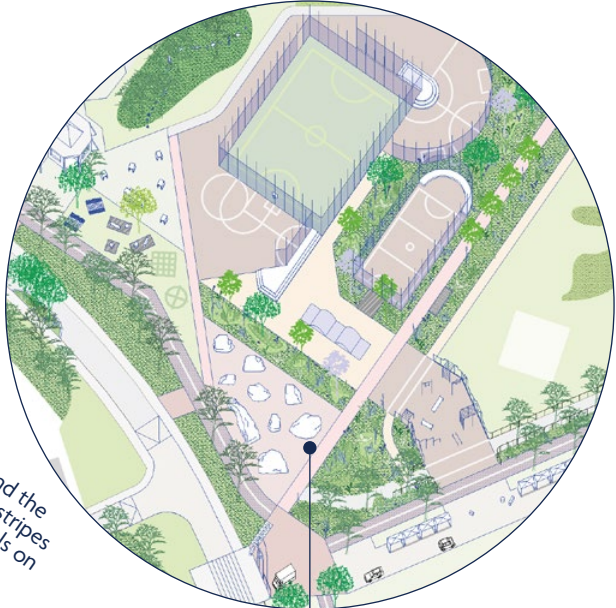

You will find the colour coded stripes next to the labels on the map.

Leisure, sports and cultural events

Events space

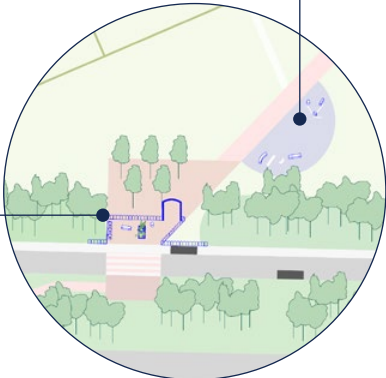

Entrances

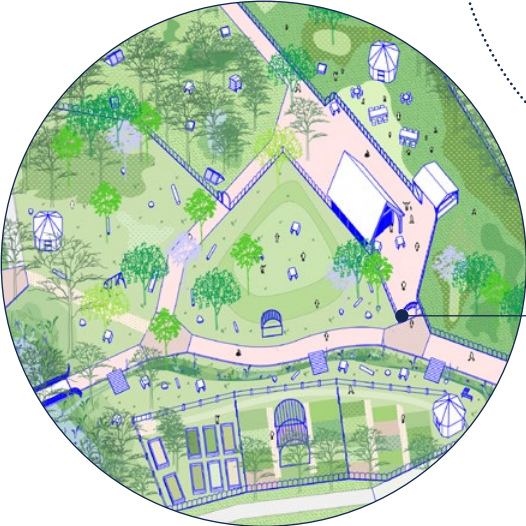

Community farm with green skills hub

Use the colour coding to find out how each of the improvements relate to the themes presented in this booklet.

# Introduction

## A destination park for all

Newham Council committed to the development of a masterplan for Beckton Parks in 2021 in order to secure a sustainable future for this valuable network of connecting green spaces.

Following an in-depth engagement exercise by We Are Street Space that collected the opinions and aspirations from over 1,500 residents and local organisations, Newham Council published the Community Vision for the Beckton Parks Masterplan in 2022. The Community Vision has formed the foundation for development and design of the Beckton Parks Masterplan.

After a year of design development, community engagement and co-design sessions, today the masterplan provides the framework for the parks to become a destination for residents across and beyond the borough, and for the space to meet objectives in relation to climate adaptation and nature recovery.

The masterplan supports the delivery of diverse and wide-ranging co-designed interventions. Each design intervention proposed will deliver the Community Vision.

The Beckton Parks Masterplan proposes to re-open parts of the parks which have not been fully accessible to the public, including its existing buildings, and giving back areas for play, active travel, relaxation, exercise, community and cultural events and access to nature. Through improved active travel routes, accessibility, and connections with other parts of the area, the masterplan provides a green, resilient, and biodiverse landscape for everyone to use.

Whilst consolidating the Community Vision, the masterplan also responds to the specific needs of key resident groups such as young people, people with special educational needs and disabilities (SEND) and the elderly. Community safety is at the heart of the design interventions, and issues such as women's safety in public space, security, health and well-being are at the forefront of the proposed framework.

The masterplan also explores the required management and maintenance strategies and how these will be delivered with ongoing community involvement and participation, to ensure local people have an opportunity to acquire training and new skills. The co-design workshops provided the opportunity to shape ideas around themed charters which will govern Beckton Parks, such as inclusivity, social sustainability, and climate change. As the landscape is enhanced, we will ensure it is increasingly climate resilient with a positive impact on air quality and management of flood risk.

By having the users, businesses and operators adhering to a common set of aims and objectives, Beckton Parks have the potential to become one of the best 'future-proofed' parks of East London and beyond.



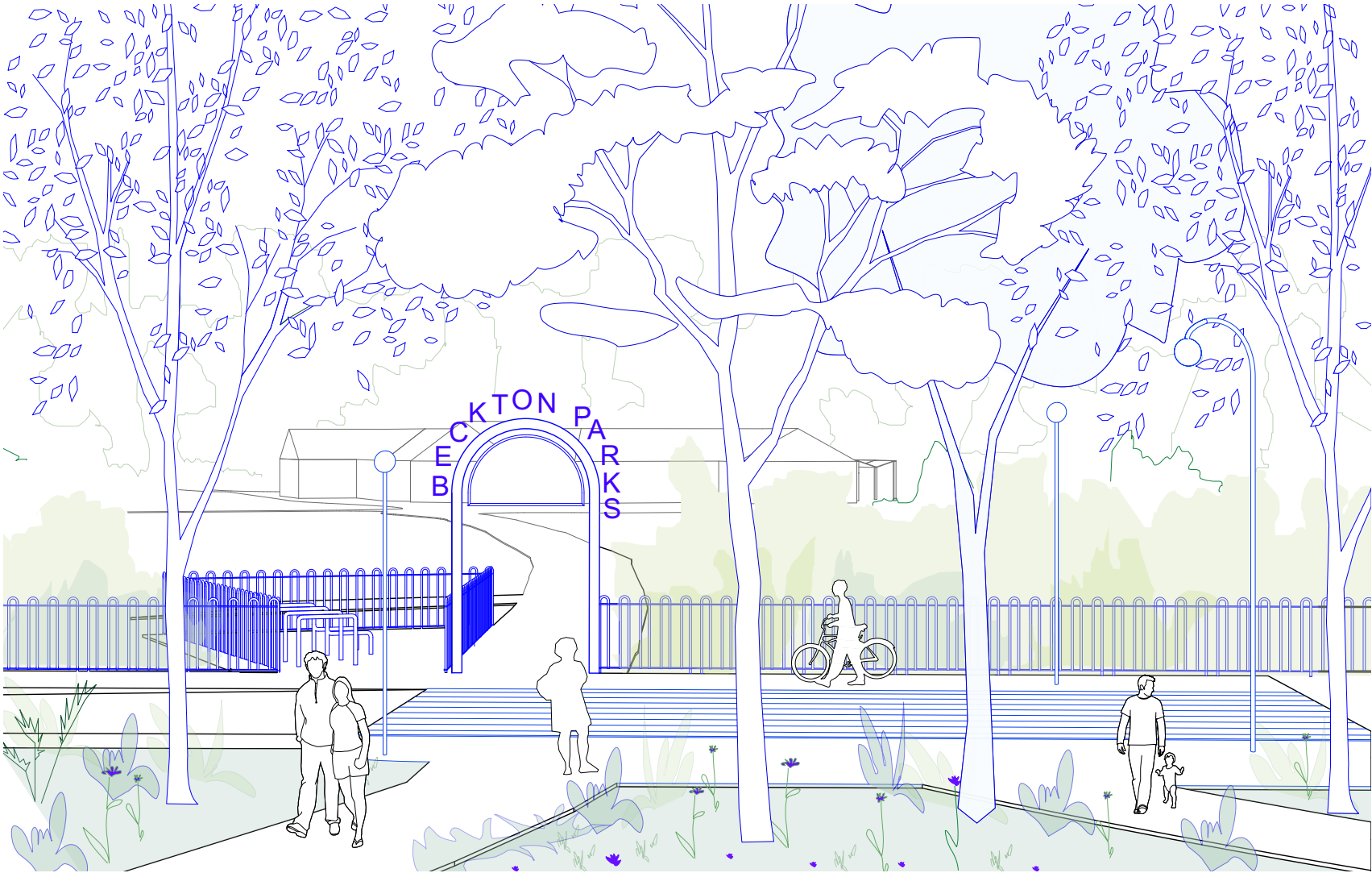

# Beckton Parks vision

## Food and flower farming



## Roads within a park



## Ecology and biodiversity

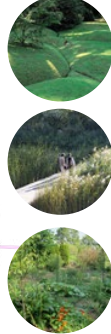

## Playful leisure destination



## Cooking, eating and selling



## Play trails



## Garden Square and community



## Learning



## Meadows and diversity in planting



## Sports and community

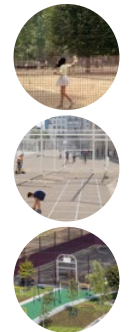

### Masterplan vision

The Beckton Parks Masterplan is a proposal for improving existing green spaces to create a destination park for Newham.

It includes proposals for a diverse network of inclusive, well managed and ecologically sustainable spaces that prioritise learning, health and well-being, safety, environmental resilience, and community involvement.

Supported by a community farm with a green skills hub within King George V Park, the vision has been built in partnership with a committed local community who have actively co-designed all elements of the masterplan through a series of engagement opportunities and workshop events over the years of 2022 and 2023. It is part of the vision that the local community will remain involved in perpetuity, learning and benefiting from access to high-quality green spaces that evolve around environmental interest, green space management, food growing, harvesting and cooking, sports and play.

The masterplan enhances the biodiversity of the parks. This includes improvements to the lake and the creation of meadows, forest gardens and spaces for food growing. Building on the local enthusiasm for the parks, the proposals include bringing the buildings within the green spaces back into use, providing community spaces and locally run cafés with public access to toilets.

The framework of new and improved routes tie in with destinations further afield, local centres and public transport. Sport facilities will include football, 5-a-side, skateboarding and parkour, basketball, running, cricket, and tennis.

The vision is for 'a park for all, accessible for all'. People of all ages and cultures will be able to continue to develop their life-long relationship with nature, sport and play, supported by high quality and long lasting infrastructure as well as accessible play and Special Educational Needs and Disabilities (SEND) spaces.



# So much to do



# Themes

**Parks for all**

**Urban  
sports**

**Green skills**

**Inclusive  
play**

**Ecology**

**Events &  
culture**

# Parks for all

## Active travel and movement

Stansfeld Road is re-imagined as an 'active travel route' and green road, where cyclists, pedestrians and cars cohabit and move through the wide extent of green spaces that form Beckton Parks. The proposal for Stansfeld Road will transform a road which currently divides the park into a road which sits within the park.

## New sense of identity and connectivity

A 'country park' approach encourages exploration and connectivity across the whole space, which will be managed as one landscape. New entrances, furniture, wayfinding and notice boards will create a visual language with a strong connection between the spaces.

Across the parks new meadows, play trails and nature walks will be implemented alongside destination uses to encourage people to use the parks to their full extent.

## Inclusivity and accessibility at its heart

The masterplan aspiration is to create an intensification of uses which complement one another to create exciting destination spaces across the parks for all to use, at different times of their life and throughout the seasons.

People are at the heart of Beckton Parks and improvements have been developed to make it an inclusive park for all, regardless of age, gender, ethnicity, sexuality and ability. Beckton Parks aspire to become a leading Special Educational Needs and Disabilities (SEND) park in London and to establish inclusivity-led design, management and maintenance processes at its heart.



“A network of community uses is peppered across the parks, with clearly identified hubs of activity, such as the Will Thorne Pavilion leisure, play and sports hub and the community farm with green skills hub.”



# Parks for all

A future vision; looking west from  
Stansfeld Road



“Places to meet, gather, learn, exercise and wander.  
Throughout its green and vast landscapes, Beckton Parks offer a variety  
of uses for a diverse community; there are spaces for everyone to  
enjoy.”





# Urban sports

## Sports for everyone

Across the parks there will be a wide range of outdoor sport courts and sport-based play opportunities for all ages, genders and abilities.

A formal sport offering is supported by informal urban sports and sport-based play opportunities, to provide for both groups and individuals. A range of informal urban sports objects such as ramps, boulders and pump tracks are also dotted around to accentuate accessibility. Play-on-the-way and natural play trails inspired by sports are offered to younger children near the sports hubs such as the Will Thorne Pavilion and the skate hub and throughout the parks.

## Sports and leisure hubs

The sports provision within the parks includes running tracks, outdoor gym, wheeled sports and parkour, tennis, cricket and football/5-a-side as well as basketball. The provision is located across the parks, building on existing facilities, established communities and user groups.

Floodlit sports courts will provide the opportunity for people to play sport all year round. To avoid creating barriers to use, court edges will be socialised with sports-based play opportunities and seating, encouraging a diversity of uses by a wide range of people. These uses are combined adjacent to the Will Thorne Pavilion, creating an intensification of both sporty and social uses, which builds upon the historical use as a hub for community and social events and as changing rooms.





“Sport-based play areas are mixed with less traditional play spaces where everyone can feel welcome and partake in the activities.”



# Urban sports

A future vision; looking east  
across King George V Park





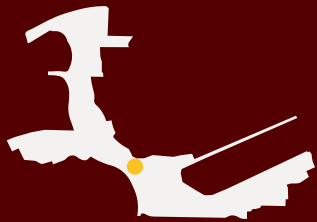

A future vision; looking north east  
towards Will Thorne Pavilion



# Green skills

## Green skills hub

The community farm with green skills hub will provide a dedicated, safe and inclusive learning environment for residents, schools and organisations to benefit from outdoor learning opportunities such as curriculum based workshops, SEND focused provision and formal learning opportunities such as horticultural apprenticeships and permaculture courses.

The reshaping of the landscape will support the creation of a sustainable working landscape to support community food growing and harvesting with the potential for inclusion of farm animals.

The green skills hub offers accredited training as well as community volunteering opportunities and celebrates up-skilling by doing things collectively. This is complemented by introducing a dedicated outdoor learning space for activities such as Forest School and school workshops.

## Growing, harvesting, cooking and eating

Traditional allotments are space hungry and, consequently, are often only available to a minority of people. A more inclusive approach based on the principles of permaculture will see shared growing spaces and forest gardens take shape across the parks. These spaces will provide more people with an opportunity to grow, harvest, learn and develop new skills and interests, and they will build cultural opportunities that create community connections and support wellbeing.

By establishing community growing spaces and forest gardening across the parks, supported by training and skills development associated with the green skills hub, similar projects in green spaces in the wider neighbourhood, in local gardens or communal green spaces, will be encouraged over time.





“Learning, training, up-skilling and collaborating are at the centre of the green skills hub ethos, but even more importantly is to be together in nature.”



# Green skills

A future vision; looking east from the centre of the community farm with green skills hub

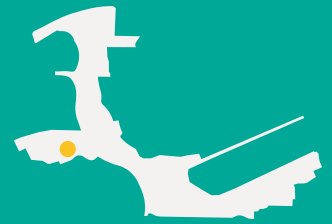



“A working landscape which sustains itself and its communities throughout the seasons, the years and generations to come.”



# Inclusive play

A future vision; connected play areas through natural trails across the parks



## Play for all

The play spaces across Beckton Parks will take account of the findings of organisations such as [makespaceforgirls.co.uk](http://makespaceforgirls.co.uk) to ensure that play opportunities and their spatial arrangement support play and socialising for everyone alongside each other; with opportunities to seamlessly move between varied spaces and opportunities on a day-to-day basis. Play is multifaceted and proposals include both formal and informal opportunities for people of all ages to play, exercise and socialise.

Play spaces will be inclusive and avoid segregating users. They will cater for a broad age range as well as for children who prefer SEND oriented spaces in close proximity, so that siblings can spend time in the parks together and with friends. They will also have social spaces, seating and hang out spaces for young adults and carers.

The large playground close to the lake will be a key destination for play across all age groups supported by a café and accessible toilets. It will act as an anchor for the community alongside the sports facilities at Will Thorne Pavilion and the urban sports hub within King George V Park and the sports gardens in the south of the parks.

## Nature play trails

Local and doorstep play will be provided across the parks.

Play-on-the-way is a strategy for a playable landscape, where formal and informal play caters for children of all ages, interests and abilities. It also acts as stepping stone to more formal opportunities for play, physical activities and social engagement.

Playable elements are designed with imagination to reflect their specific location so that the trail becomes one of exploration and reflection; fun, physical and educational.



“Different play spaces providing a playful landscape throughout, that welcomes everyone.”



# Inclusive play

A future vision; looking north across  
the inclusive play space

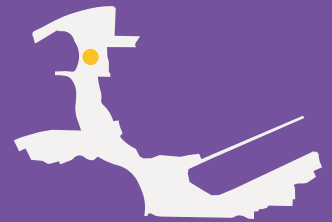



“Play spaces celebrate rich experiences and informal play opportunities, offering areas for all ages, genders and abilities.”

## Green infrastructure as a response

The existing parks are the largest area of Council owned green space in the borough. Collectively they form a linear green space traversing the southern part of the borough connecting the Greenway with the Royal Docks and Beckton Riverside.

The essence of a park is that it is a predominantly green and semi-natural landscape that provides a contrast to and respite from the urban landscape by which it is surrounded. Taking a green infrastructure rather than a green space approach to designing the existing spaces establishes a series of linked and coherent places that function as a whole as well as independently.

## Biodiversity and nature recovery

Beckton parks already provide a variety of habitats including planted woodlands, wildflower meadows and the lake. By developing bespoke management plans for the existing areas of semi-natural habitat within Beckton Parks, the spaces for wildlife will be improved by, for example, creating glades in the planted woodlands. This will maximise the existing spaces biodiversity value while the ecological connections between them is optimised.

Transitional spaces, carefully created between different habitat types (ecotones) will be some of the most ecologically rich and bio-diverse environments within the parks and the opportunities for creating ecotones will be maximised to increase the variety of wildlife using and moving through them.

Niche habitats, such as bee posts, stag beetle loggeries, beetle bumps and planting for pollinators will be established throughout the parks. Tying in with the green skills hub strategy, this will delivery nature recovery at a smaller scale that can be replicated by others beyond the parks boundaries.



“A series of new meadows, woodlands and on-street greening will create a unified ecological network across the parks, placing nature, wildlife and resilience at the heart of everything.”



# Ecology

A future vision; looking north west  
across Tollgate Road





## Climate resilience

Our climate is changing and Beckton Parks will play an important role in mitigating climate change locally. Through strategic planting of trees and the management of existing wooded areas within the parks the cooling effects of the urban forest will be increased. Walkways and play spaces will be shaded, and by improving the structure of existing woodlands areas, sun traps will also be created to provide benefits at different times of the year.

## What should your parks do for the future?

A direct outcome of the co-design workshops are an Environmental and Inclusivity Charter for Beckton Parks that will have the users and operators adhering to a common set of aims and objectives.

Beckton Parks has the potential to become one of the best 'future-proofed' parks of East London and beyond by aiming to :

- Become a net zero park.
- Become a circular economy park.
- Become a climate resilient park.
- Become a nature recovery park.

## Water strategies

The communities and neighbourhoods bordering Beckton Parks are vulnerable to the physical impacts of climate change due to the low-lying geography of this part of the borough, which increases surface water flood risk.

By making drainage a visible rather than a hidden infrastructure it reveals how winter rain and summer storms need to be managed differently in the future, through dispersal and infiltration of rainwater rather than discharge to an overburdened piped system. Swales will be created alongside some of the roads that border or traverse the parks alongside rain gardens associated with existing and refurbished buildings so that rainwater run-off from roofs and hard-surfaces becomes a resource to support biodiverse planting rather than a waste to be flushed away.

# Ecology

A future vision; looking south east  
across the lake

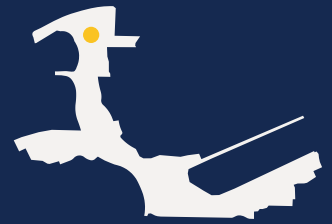



“Reed beds along the perimeter of the lake create habitats for a variety of flora and fauna, it is particularly appealing for birds to nest. The dense foliage and softer edge increases the existing biodiversity.”



# Ecology

Future vision; looking south east from the westerly edge of the sports gardens





“Exercising in nature; sports facilities for all are located across the rich and varied landscapes of Beckton Parks.”



# Events & culture

## Cultural and commercial events

Co-developed public art throughout a series of site-specific interventions with residents, will enable active participation in the design of the parks. Public art supports the place-making and way-finding strategies for the masterplan, and could take many different forms, from signage and sculptures to play equipment.

The scale of the parks provides potential to host a variety of community events, local celebrations, and cultural festivals, from funfairs to more commercial events on a regional scale.

To support this activity the masterplan contains a designated events and market space which includes hard surfaced areas with vehicular access and access to power and water. The flexibility in designs of the event spaces allows for a rich and varied offering throughout the year.



A future vision; looking south towards the DLR station and the meadows





# Events & culture

A future vision; looking south from the Beckton corridor

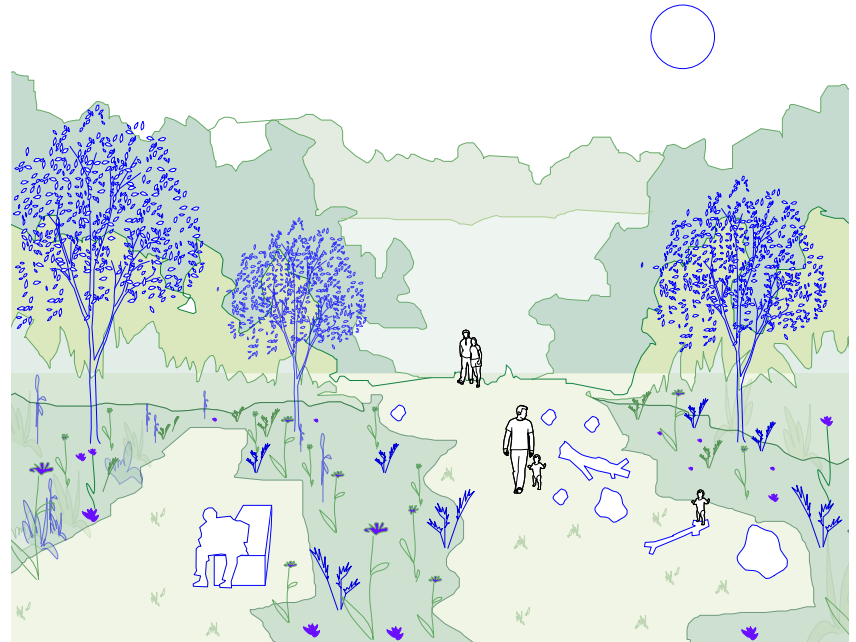
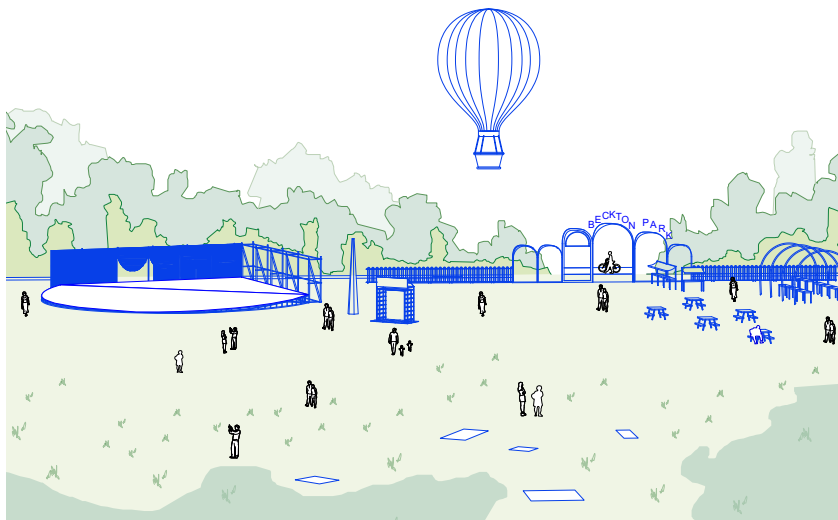

“The proximity to Beckton Park DLR station makes the south of Beckton Parks an ideal terrain for a wide range of events.”

With thanks to the Beckton and Custom House communities who have contributed so much time, consideration and energy towards the design of the Beckton Parks Masterplan.

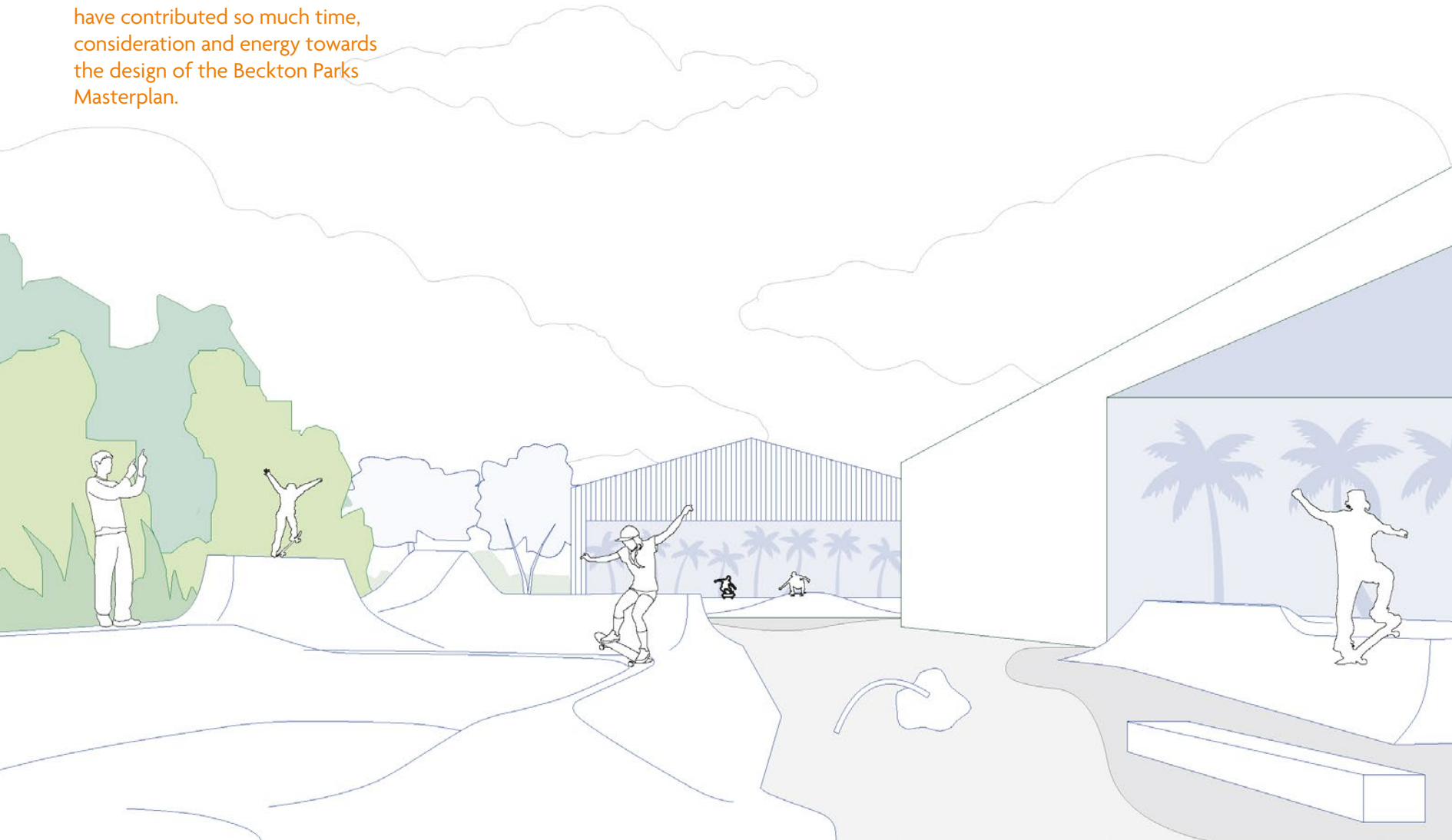





East  
architecture  
landscape  
urban design  
east.uk.com

with  
Peter Massini

All images and drawings  
are the property of East,  
architecture, landscape  
and urban design.

Photographs by:  
Jakob Spriestersbach.

**WE ARE NEWHAM.**

For more information about the  
Beckton Parks Masterplan please  
visit:  
[www.newham.gov.uk/becktonparks](http://www.newham.gov.uk/becktonparks)

